



MANUAL TRAY SEALER

S 190

This manual machine seals hermetic film on trays up to 270 x 190 mm made from plastic, carton or sugar cane pulp. Thanks to its power-assisted system, pressure is applied without effort, for constant result whatever the operator is.

Maximum tray size: 270 x 190 mm

S 190



Uses



Catering professions



Groceries & supermarkets



Optional: made-to-measure heating plate and mould for other trays.



- ✓ Compact and easy to use, for sealing small and medium-sized trays up to a maximum size of 270 x 190 mm.
- ✓ Handle system with reinforced pressure for easy, effortless sealing.
- ✓ Electronic temperature control and adjustment via soft keyboard.
- ✓ Stainless steel structure for easy cleaning and better resistance to disinfectants (reduces retention zones).



1 year warranty⁽¹⁾

⁽¹⁾Except wear parts









Compatible materials
Bio-sourced or compostable

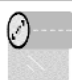

Compliance with
CE standards

FOOD range

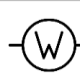
TECHNICAL DATA

MODEL							
S 190	55,5 x 28 x 61 cm	190 mm (max)	200 mm (max)	soft keyboard	12 kg	1000 W	230 V 50/60 Hz

* Dimensions open cover

EQUIPMENT

System with assistance:
effortless pressure
reinforced

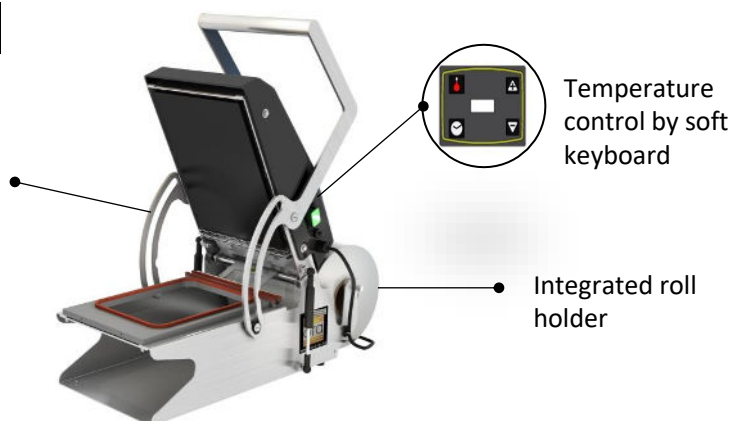

ADAPTED TOOLS

MOULD

Options: made-to-measure mould for other tray dimension
(please contact us).

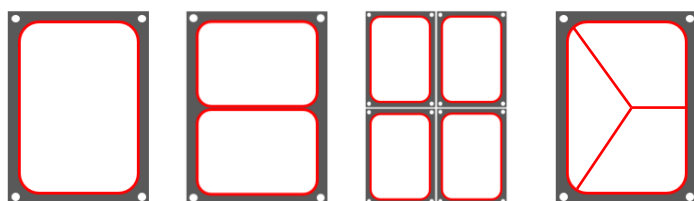

TRAY

Max. tray height



OPERATING PRINCIPLE

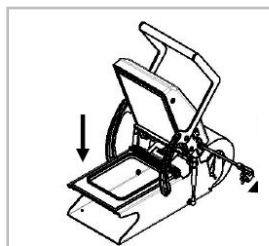

Place your tray and its contents on the mould.

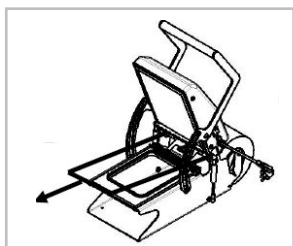

Unroll the film over the tray.

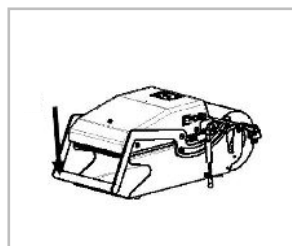

Lower the handle to cut and seal the film.

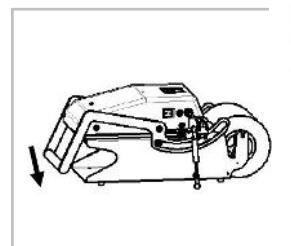

Keep the 2 handles pressed together for a few seconds.

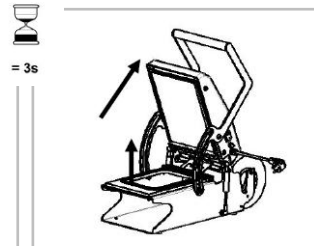

The tray is sealed and ready to use.

Need more information?



Contact the sales department: +33 (0)4 74 00 59 54